



Artistic rendition of the FCLC (front) with workforce housing (back).



Family Community **LIFE CENTER**

Families are the heart of the Community

1018 Northville Turnpike • Riverhead, New York 11901



Artistic rendition of the Family Community Life Center.



Family Community **LIFE CENTER**

Families are the heart of the Community

1018 Northville Turnpike • Riverhead, New York 11901 • Phone: 631.727.1110

Family Community Life Center, Inc. (FCLC) is a community-based 501(c)3 organization. Through its social, educational, recreational and cultural programs, FCLC promotes quality family life and a greater sense of community among residents in Riverhead and neighboring districts.

Area resident surveys conducted over a number of years indicate a current and growing need for safe, quality recreational facilities and intergenerational services in Riverhead and other East End communities. To address these expressed needs, FCLC will erect a comprehensive permanent facility.

Easily accessible from Long Island's North and South Forks, as well as points west of Riverhead, FCLC will be centrally located at Northville Turnpike on a twelve-acre site owned by the First Baptist Church of Riverhead.

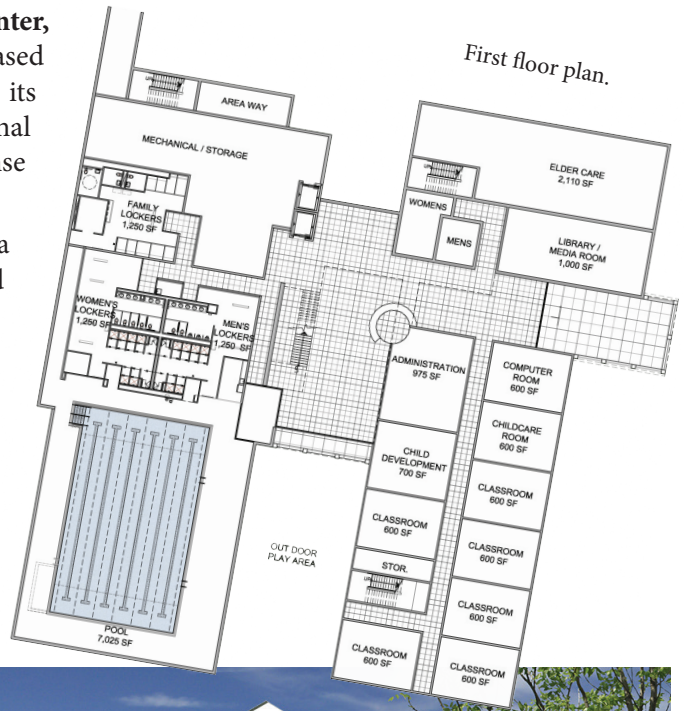

- Swimming pool
- Performing arts theater
- Child care center
- Adult day care facilities
- Fitness center
- Indoor walking track
- Gymnasium
- Community education classrooms
- Walking paths
- Rental housing
- Garage & storage building



Baldassano ARCHITECTURE



FCLC's complex will be a comprehensive facility featuring a community of buildings connected around a main atrium. The interconnected buildings will include a performing arts theater, a 24-hour childcare facility (the Child Development and Learning Center or CDLC), a senior citizen wellness and daycare center, and a major sports and recreational compound. 100 one and 25 two-bedroom apartment units will frame the center complex, providing the community with critically needed rental housing.

All of FCLC's facilities, including its pool, gymnasium, fitness center and indoor walking track, will be available for year-round use. FCLC's planned Community Benefit District will answer the many needs of the East End community by creating a hub where families can come together to learn, live, work and play.